



TRINITY AG CAPITAL CAMPAIGN



GOSPEL  
TRANSFORMATION  
IN EVERY AREA  
OF OUR LIFE,  
AND IN EVERY LIFE  
IN OUR AREA.





## LETTER FROM PASTOR DAVID

September is my favorite month of the year mostly because I love the changing of the seasons from summer to fall. Some of you also look forward to this time of year. The crisp air, outdoor activities, football, the food and of course, the holidays. But I know for others, summer is hard to let go of, or maybe there's some worry about the season that comes after fall!

Regardless of how you feel about fall...one thing's for sure: come September, we all know—the seasons are changing. It's time.

In the same way, there are seasons and times in the kingdom of God. Ecclesiastes 3:1 reminds us, 'For everything, there is a season, and a time for every purpose under heaven.'

**At Trinity Assembly, we're stepping into a new season.** Over the next three years, we'll be celebrating some significant milestones: our 40th anniversary as a church, 30 years on this property here in Clay, and for me, 10 years serving as your lead pastor.

The Lord has made it clear to us through His provision, the growth of His church, and the growth of our community— the seasons are changing....it's time for what's next. It's time.

This booklet will walk you through our story, our growth, our opportunity, and our future.

As a church, we are deeply rooted in a call to **SEEK** His kingdom first. We are a growing church in a growing community and that requires us to **STRETCH**. Our opportunity is connected to our willingness to **SACRIFICE** in generous ways. And our future is one that invites us to **SOW** now so others may reap later.

### It's a new season.

Charles Spurgeon once said, 'The seasons change, and you change, but the Lord abides evermore the same, and the streams of His love are as deep, as broad, and as full as ever.'

The same God - who has guided us so faithfully through every previous season, will faithfully lead us forward into a new season.

### IT'S TIME.

- Pastor David

"FOR EVERYTHING,  
THERE IS A SEASON,  
AND A TIME FOR  
EVERY PURPOSE  
UNDER HEAVEN."

ECCLESIASTES 3:1



BUT SEEK FIRST HIS KINGDOM AND  
HIS RIGHTEOUSNESS, AND ALL THESE  
THINGS WILL BE GIVEN TO YOU AS WELL.

MATTHEW 6:33

# OUR STORY

Throughout every chapter of our story, one thing has remained constant: **God's faithfulness to His people and through His people.**

From our humble beginnings—a small group gathered in the back room of an office building—Trinity Assembly of God has grown both in size and in impact. Through our ministry, people locally and around the world have heard the good news of the gospel and experienced its transformative power. We remain steadfast in our commitment to the mission of making disciples for the glory of our God and the good of our community.



## 2005

In August 2005, TAG moved into a 7,000 square foot all-purpose building—debt-free, another testament to God's provision.



## 1986

In July 1986, Thomas J. Hertweck, along with his wife Eunhee and their children Lisa, David, and Joshua, returned to New York State after completing their studies at Central Bible College and the Assemblies of God Theological Seminary in Springfield, Missouri. With a heart to serve, the New York District of the Assemblies of God called them to plant a new church in Liverpool, NY. They began meeting at the NY District Office building, and after a month of preparation, Trinity Assembly of God held its first service on August 24, 1986, with 25 attendees.

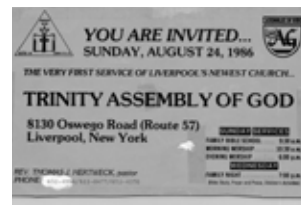

## 2017 - 2018

In February 2017, Pastor Tom went home to be with Jesus. He had faithfully served as pastor of the church for over 30 years. Later that year, the church membership elected Pastor David as Trinity's next lead pastor, and he officially began serving in that role on January 1, 2018.



## 1987-1997

As God continued to bless the ministry, the congregation outgrew its space and moved to Wetzel Road Elementary School in 1987. By 1988, TAG became a General Council Affiliated church, receiving its Certificate of Incorporation, with average attendance reaching 75.

In 1991, God opened the door for TAG to purchase six acres of land on Route 31, the future home of their church building. By April 1997, the congregation moved into a new 9,110-square-foot facility, signifying a major milestone.



## 2023-2024

In 2023, the church leadership initiated plans for an expansion project, hiring Whelan and Curry, a local design-build firm. The church also brought on Injoy Stewardship Solutions as a consultant to help develop the project's financing strategy. In March 2024, Pastor Eunhee went home to be with Jesus. We thank God for our founding pastors and their many faithful years of servant leadership. It is our honor to continue the work that God began through them.



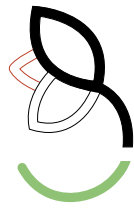

## THE LAST SEVEN YEARS

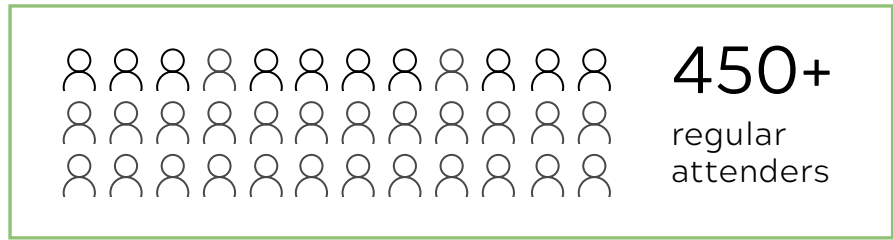

“ Over the past seven years, we have witnessed Jesus faithfully building His church. It has been a great joy to partner in His work and strive to steward well what He has entrusted to us. While the numerical growth is encouraging and worth celebrating, the deeper, more significant progress has been in strengthening our focus and strategy for being a disciple-making community. ”

**PASTOR DAVID**

- NEW DISCIPLESHIP INITIATIVES**
- Dinner Parties
  - Discover Trinity
  - C3 Groups
  - Learn Together classes
  - Weekly Pray Together
  - Worship Together evenings
  - Connection Room
  - TK Pre-K



DO NOTHING OUT OF SELFISH AMBITION OR VAIN CONCEIT. RATHER, IN HUMILITY VALUE OTHERS ABOVE YOURSELVES, NOT LOOKING TO YOUR OWN INTERESTS BUT EACH OF YOU TO THE INTERESTS OF THE OTHERS.

**PHILIPPIANS 2:3-4**

### OUR SURROUNDING COMMUNITY

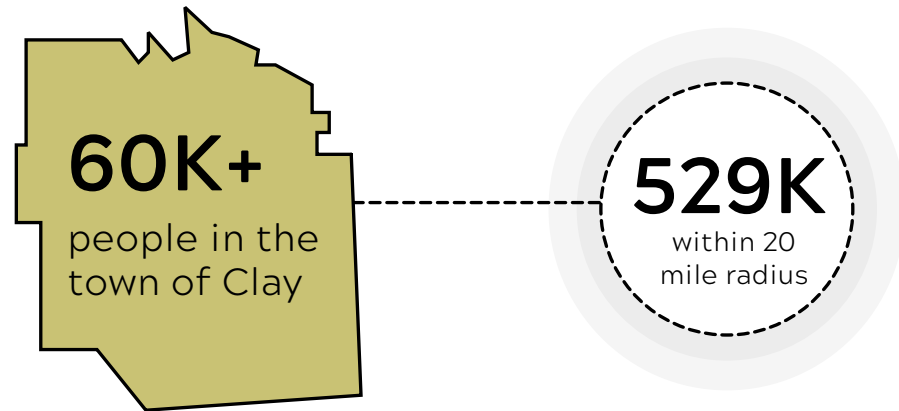

#### PAID OFF

- Land mortgage
- Building mortgage

#### RENOVATED

- Lobby
- Cafe
- Sanctuary
- Nursery
- Bathrooms
- Classrooms



## THE WHAT + WHY



**Heart of  
Hospitality**

### **PARKING LOT EXPANSION**

**120+ additional** parking spots  
Comfort & care for our church  
family & guests



**Heart for the  
Next Generation**

### **NEXT GEN ATRIUM | 500 SF**

Safety & convenience for  
families & children



**Heart for  
Our Leadership**

### **OFFICE SPACE | 2200 SF**

Great working environment  
for our team



**Heart for  
Healthy Growth**

### **SANCTUARY | 2200 SF**

Space for a growing community to  
gather



**Heart of  
Stewardship  
& Care**

### **STORAGE | 1400 SF**

Secure space to store  
& take care of our  
resources

# PROJECT PLAN



SCAN THE QR CODE  
to view the full rendering video

**A**  
Heart of Hospitality  
**PARKING LOT EXPANSION**

**B**  
Heart for the Next Generation  
**NEXT GEN ATRIUM**

**C**  
Heart for Healthy Growth  
**SANCTUARY**

**D**  
Heart for our Leadership  
**OFFICE SPACE**

**E**  
Heart of Stewardship & Care  
**STORAGE**

## PROJECT DATES

Projected start time: **Early 2025**  
Projected completion time: **Dec 2025**

**PROJECT COST: \$3-3.5 Million**

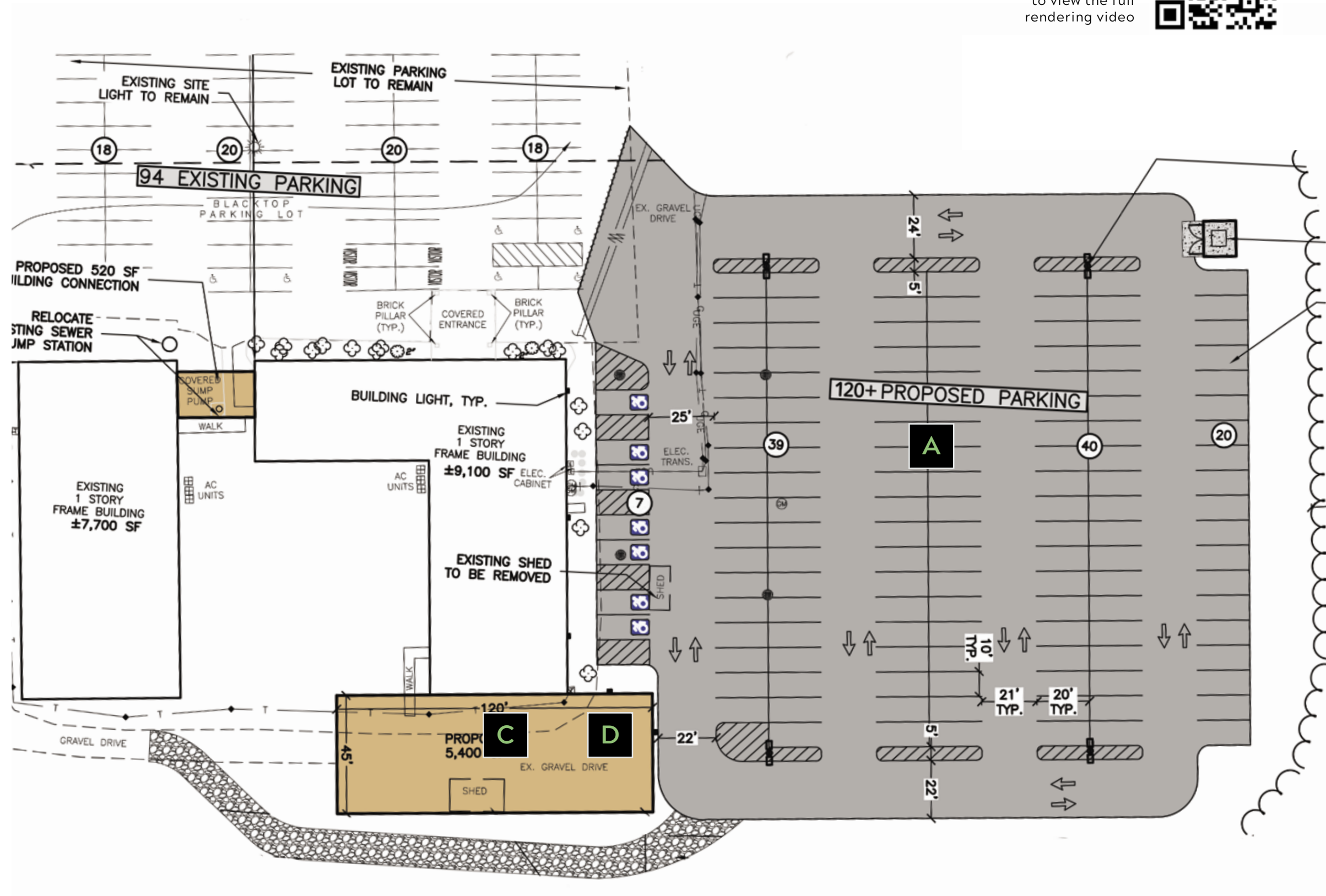

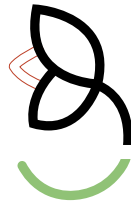

BUT THE KING REPLIED TO ARAUNAH, "NO, I INSIST ON PAYING YOU FOR IT. I WILL NOT SACRIFICE TO THE LORD MY GOD BURNT OFFERINGS THAT COST ME NOTHING."

**2 SAMUEL 24:24**

## HOW YOU CAN HELP US GROW

We are a growing church in a growing community, and it's time to seek, stretch, sacrifice and sow for both our current needs and the exciting future that God is leading us into!

We're inviting every individual and family in our church to prayerfully consider the sacrifice God is calling you to make as we work together to make more room to make more disciples. This journey isn't about equal giving—it's about equal sacrifice. It won't be accomplished through a few large gifts, but through the faithful sacrifices of many.

At Trinity Assembly, we often speak about giving in four ways: Cheerfully, willingly, sacrificially, and expectantly. We don't give to earn God's love or secure His favor—we give because He has already poured out His grace and mercy upon us. Knowing this frees us to open our hearts and hands with joyful generosity.

We are asking you to prayerfully commit to a three-year pledge toward our It's Time project, a gift above and beyond your regular giving. This sacrifice will help shape the future of our church as we continue to make room to make disciples.

### GUIDE FOR GIVING

WEEKLY	MONTHLY	3 YEARS
\$962	\$4,167	\$150,000
\$642	\$2,778	\$100,000
\$481	\$2,084	\$75,000
\$321	\$1,389	\$50,000
\$257	\$1,112	\$40,000
\$193	\$834	\$30,000
\$161	\$695	\$25,000
\$129	\$556	\$20,000
\$97	\$417	\$15,000
\$65	\$278	\$10,000
\$52	\$223	\$8,000
\$32	\$139	\$5,000
\$26	\$112	\$4,000
\$20	\$84	\$3,000

**FINANCIAL GOALS**

**1.25 MILLION**

over the course of 3 years

**Stay Faithful to Jesus**  
Jesus & His gospel must remain at the center of it all.

**Stay Focused on the Mission**  
Our mission is to make disciples for the glory of God and the good of our community.

**See Beyond Our Own Lifetimes.**  
Sow without reaping. It's Time.



## FAQ

### WHO IS OVERSEEING THE PROJECT, AND HOW WILL PROGRESS BE COMMUNICATED?

A dedicated team, in partnership with the church leadership and external contractors, is overseeing the project. Regular progress updates will be shared through our Sunday services, church website, email, and social media channels. We aim to keep the church informed and engaged every step of the way.

### HOW WILL THE EXPANSION IMPACT THE CONGREGATION DURING CONSTRUCTION?

During construction, there may be temporary changes in parking, entrances, and meeting spaces. We will do our best to minimize disruptions, and we'll provide regular updates so the congregation knows what to expect. Our goal is to maintain as much continuity as possible in worship services and ministry activities while ensuring everyone's safety.

### WILL WE REDUCE OUR SPENDING IN MINISTRY TO BUILD THIS EXPANSION?

No, we are committed to continuing our ministry work at the same level, even as we pursue this building expansion. The capital campaign and construction costs are separate from our regular ministry budget, and we will not divert funds away from our ongoing programs and outreach. Our mission remains focused on serving our church and community, and we believe this expansion will ultimately strengthen and increase our ministry impact.

### WHAT ROLE DO VOLUNTEERS PLAY IN THE CAPITAL CAMPAIGN AND CONSTRUCTION?

Volunteers are essential to the success of the capital campaign and the construction project! Throughout the campaign, volunteers will help with communication, fundraising events, prayer

initiatives, and community engagement. As for construction, while most of the work will be handled by professionals, there will be opportunities for volunteers to assist with smaller projects, clean-up, and preparing the spaces for use. Your time and talents are invaluable to making this vision a reality!

### WHAT IS THE CHURCH'S PLAN TO MAINTAIN AND CARE FOR THE EXPANDED FACILITIES?

Our church is committed to ensuring that the expanded facilities are well-maintained and cared for. We will incorporate the costs of maintenance, cleaning, and general upkeep into the annual operating budget. Additionally, we will monitor the needs of the new and existing spaces. Our goal is to ensure that the expanded facilities serve our church and community for years to come.

### WHAT HAPPENS IF WE EXCEED THE \$1.25 MILLION FUNDRAISING GOAL?

Exceeding the \$1.25 million goal would be an incredible blessing! Any additional funds will go towards reducing the total loan amount needed for the project and allow the church to allocate more resources toward ministry opportunities and community outreach.

### WHAT HAPPENS IF THE FUNDRAISING GOAL IS NOT MET?

If we do not meet the \$1.25 million fundraising goal, the leadership will reevaluate the scope and timeline of the project. Our commitment to good stewardship and wise financial decisions remains, and we will carefully discern the best path forward to ensure we meet the needs of our growing church.



## BIBLICAL PRINCIPLES



DO NOT BE DECEIVED: GOD CANNOT BE MOCKED. A MAN REAPS WHAT HE SOWS. WHOEVER SOWS TO PLEASE THEIR FLESH, FROM THE FLESH WILL REAP DESTRUCTION; WHOEVER SOWS TO PLEASE THE SPIRIT, FROM THE SPIRIT WILL REAP ETERNAL LIFE. LET US NOT BECOME WEARY IN DOING GOOD, FOR AT THE PROPER TIME WE WILL REAP A HARVEST IF WE DO NOT GIVE UP.

**GALATIANS 6:7-9**

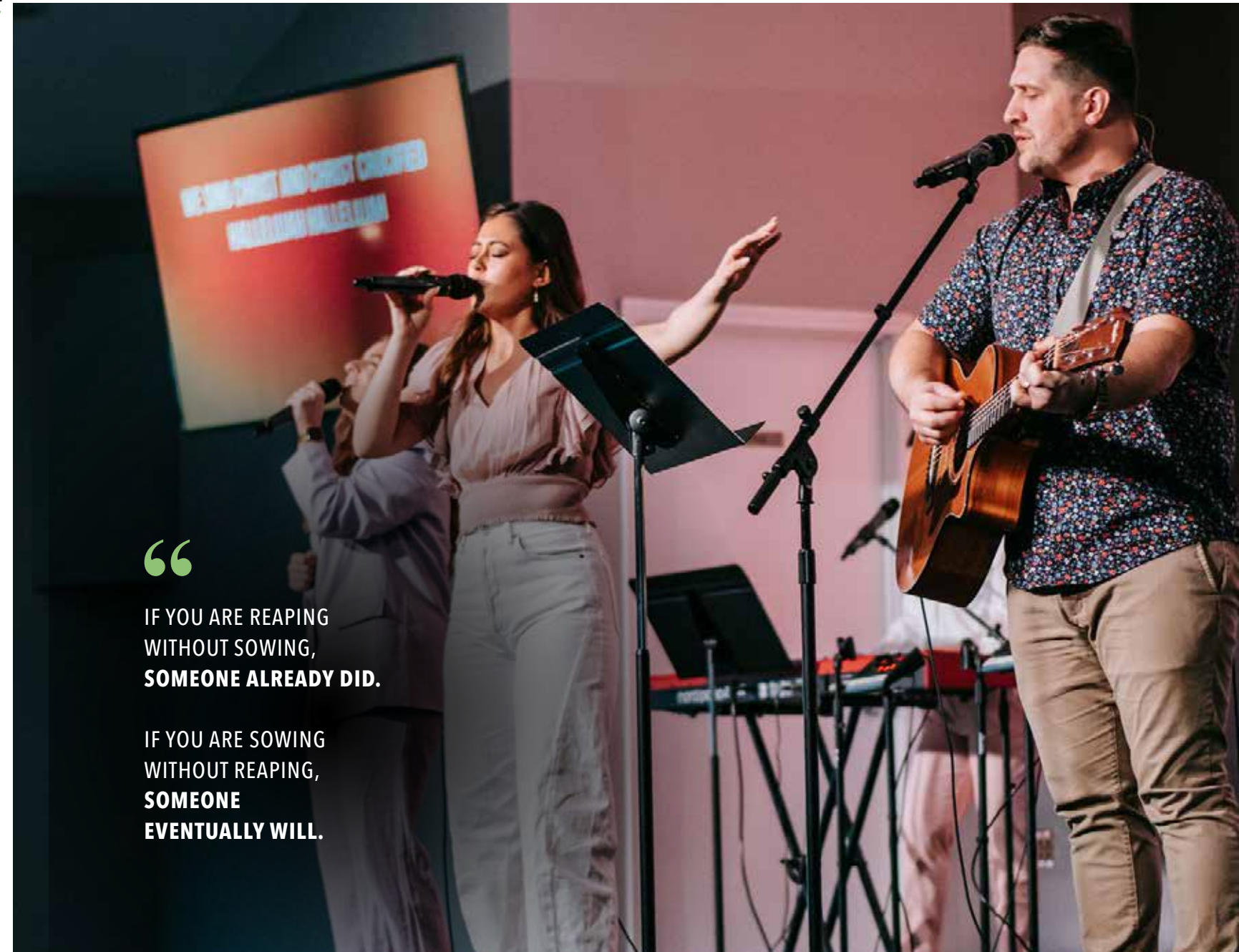

“

IF YOU ARE REAPING WITHOUT SOWING, **SOMEONE ALREADY DID.**

IF YOU ARE SOWING WITHOUT REAPING, **SOMEONE EVENTUALLY WILL.**

1

**SOWING = REAPING**

WHAT A MAN SOWS, HE WILL REAP

**GALATIANS 6:7-9**

2

**SOWING = TEARS**

THEY WHO SOW IN TEARS, WILL REAP IN JOY

**PSALMS 126:5-6**

3

**X SOWING = Y REAPING**

ONE MAN SOWS AND ANOTHER REAPS

**JOHN 4:37**

4

**GOD > SOWING + REAPING**

GOD WAS CAUSING THE GROWTH

**1 CORINTHIANS 3:6-11**

**TRINITY**  
**ASSEMBLY**  
CLAY • NEW YORK

CAPITAL CAMPAIGN

